

# Changing the Encoder Resolution on a DRO203 & DRO30X





# Changing the Encoder Resolution on a DRO203 & DRO30X

Note which port the encoder you need to change is plugged into. You will need this information for later.

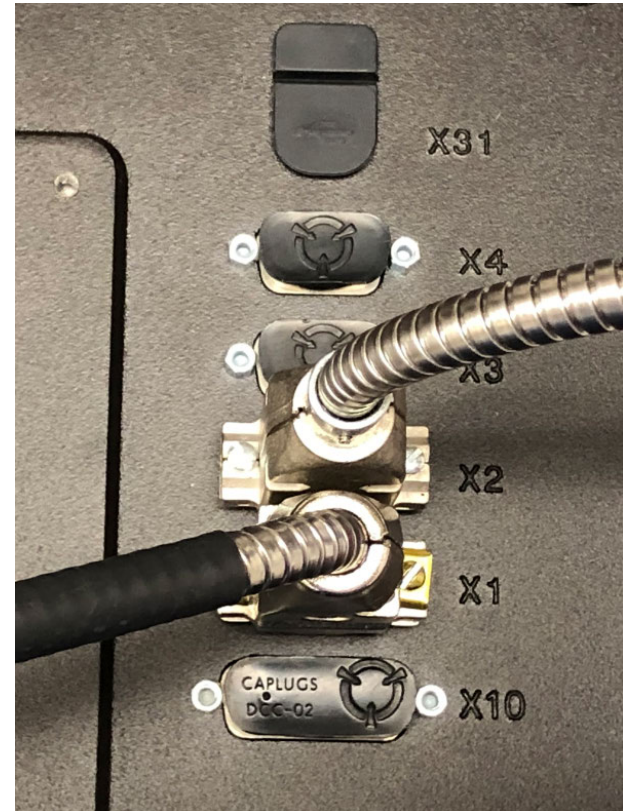



# Changing the Encoder Resolution on a DRO203 & DRO30X

Power up the box.  
When prompted,  
press any key to  
continue.



The power switch is located on the back,  
directly under the power cord.



# Changing the Encoder Resolution on a DRO203 & DRO30X

Reference your encoders by moving each axes so they cross at least 2 reference marks on the glass (~3").

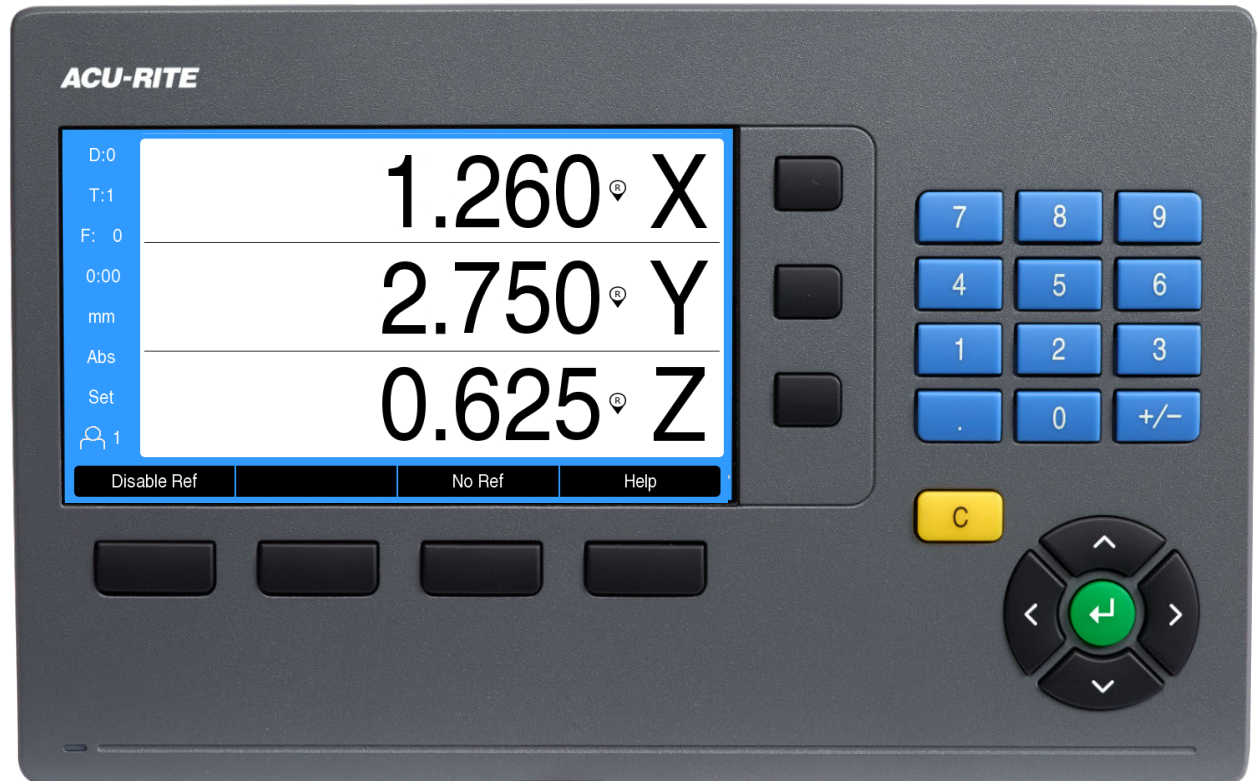



# Changing the Encoder Resolution on a DRO203 & DRO30X

Use the left or right arrow keys to change the soft key menu below the screen, until you find the Setup menu.





# Changing the Encoder Resolution on a DRO203 & DRO30X

Press the Setup  
soft key.





# Changing the Encoder Resolution on a DRO203 & DRO30X

Use the up and down arrow keys to highlight the User Management menu, then press enter.





# Changing the Encoder Resolution on a DRO203 & DRO30X

Use the up and down arrow keys to highlight the Supervisor Login menu, then press enter.





# Changing the Encoder Resolution on a DRO203 & DRO30X

Using the number keypad to enter the passcode – 8891, then press enter.





# Changing the Encoder Resolution on a DRO203 & DRO30X

Use the left arrow key to return to the Configuration Menu.

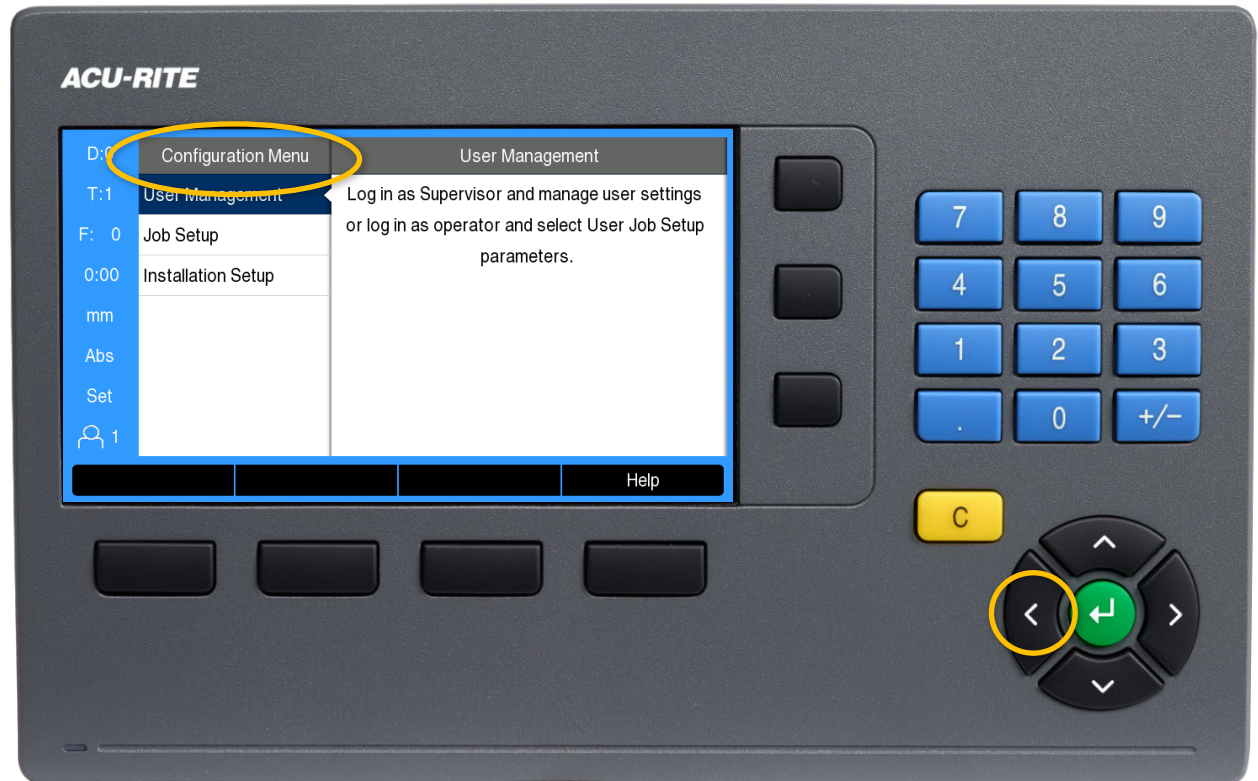



# Changing the Encoder Resolution on a DRO203 & DRO30X

Use the up and down arrow keys to highlight the Installation Setup menu, and then press enter.

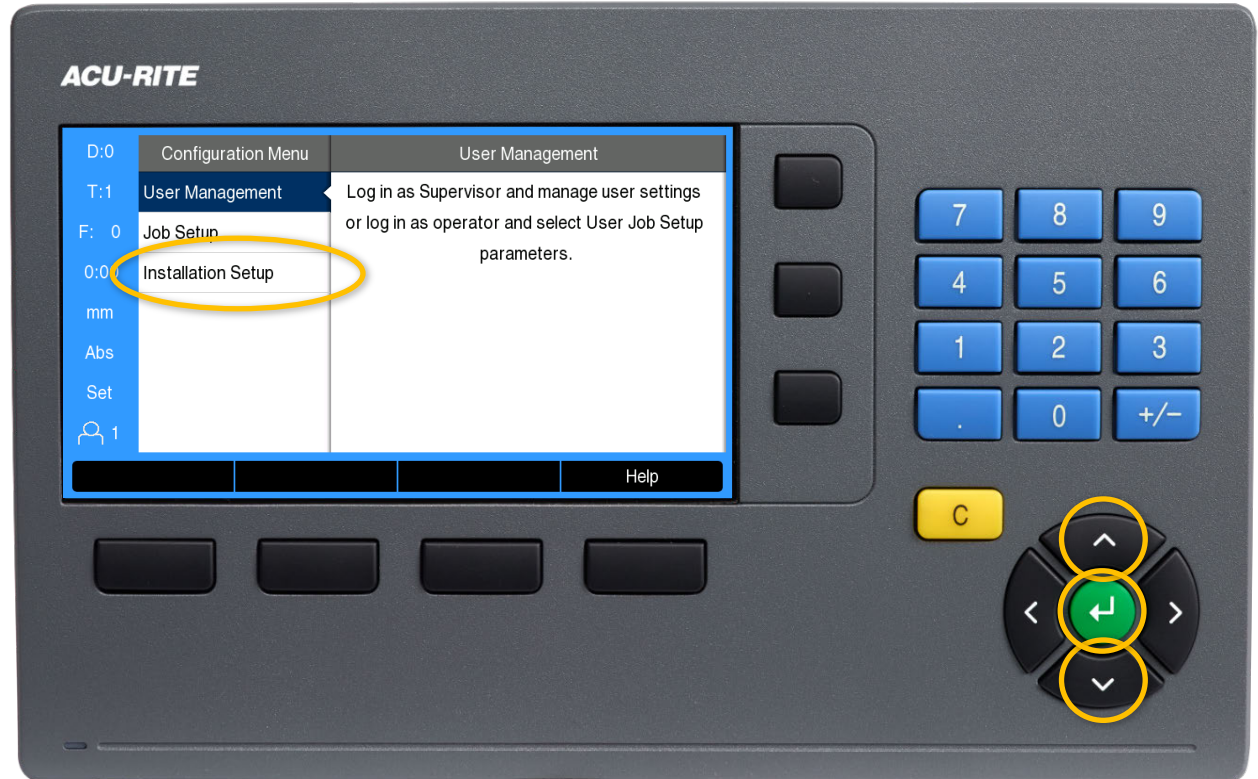



# Changing the Encoder Resolution on a DRO203 & DRO30X

Use the up and down arrow keys to highlight the Encoder Setup menu, and then press the right arrow key.

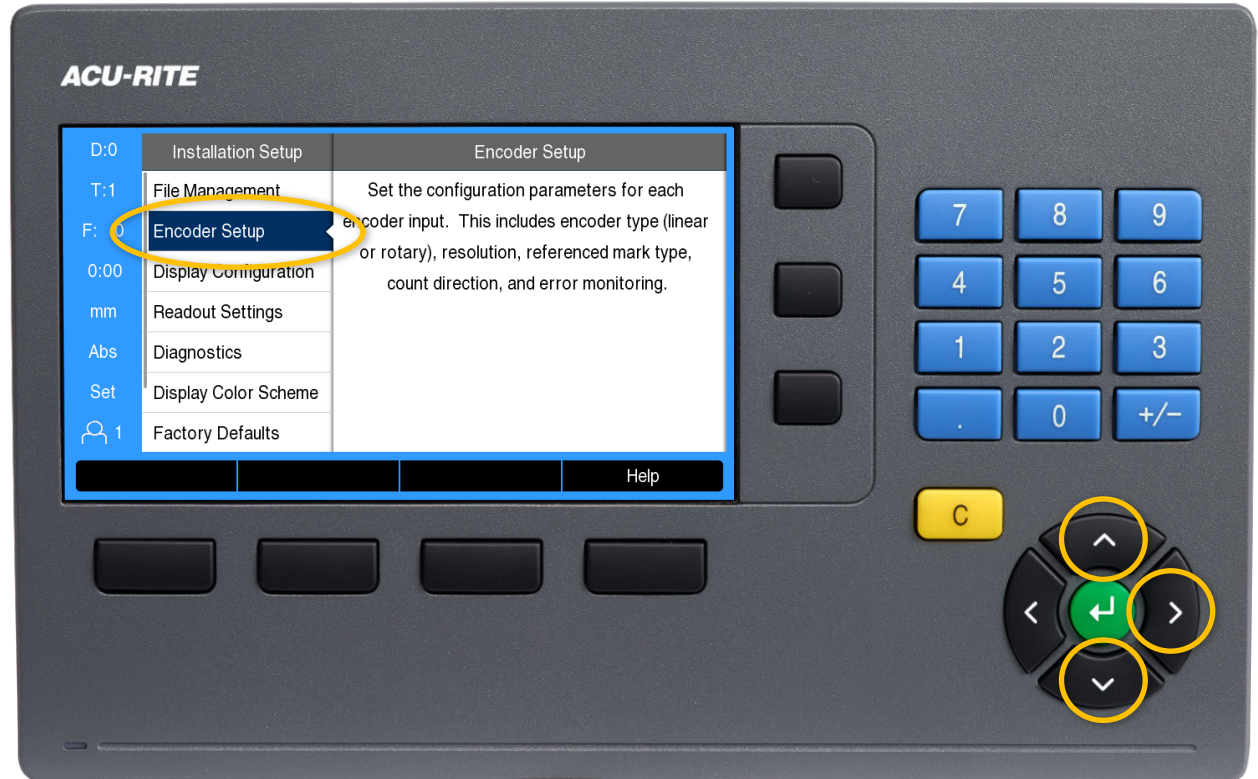



# Changing the Encoder Resolution on a DRO203 & DRO30X

Use the up and down arrow keys to highlight the port the encoder you want to change is plugged into, and then press enter.





# Changing the Encoder Resolution on a DRO203 & DRO30X

Use the up and down arrow keys to highlight the Resolution menu, and then press the right arrow key.





# Changing the Encoder Resolution on a DRO203 & DRO30X

Use the up and down arrow keys to highlight the resolution that matches the value listed on the encoder label, and then press enter twice.





# Changing the Encoder Resolution on a DRO203 & DRO30X

Press the left arrow key three times to get back to the DRO screen. Repeat the sequence for additional encoders as needed.

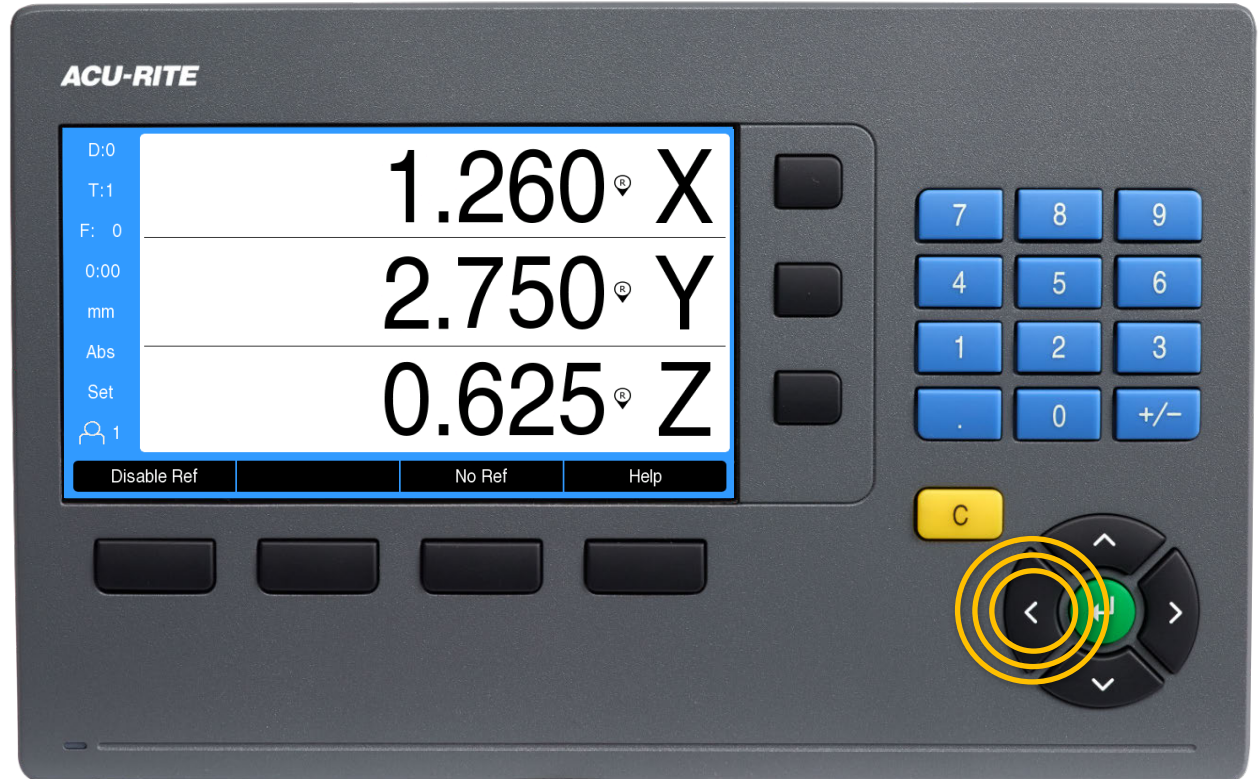



# ACU-RITE®

## What's in your shop?

ACU-RITE's NEW complete line of performance-driven  
Digital Readout Systems for all of your manual machine applications:  
Milling, Turning, Grinding, Boring, EDMs



[www.acu-rite.com](http://www.acu-rite.com)



Digital Readout Systems | Precision Linear Encoders | MILLPWR® CNC Retrofit Packages for Knee and Bed Mill Machines  
333 E. State Parkway, Schaumburg, IL 60173 | (847) 490-1191

# ACU-RITE®